



38 South Pacific Avenue, MOUNT PRITCHARD NSW

4 1 2

Truly a wonderful family Home, Vendors are committed to selling & giving you a fantastic buying opportunity.

- + Spacious living areas with comfort flowing to the outdoor area
- + Separate Formal Lounge and dining room + Large family room
- + Generous kitchen with plenty cupboard space bench area, walk in pantry
- + Four bedrooms, with built-in wardrobes to 2 brs.
- + Updated bathroom with separate shower & bath, Two Toilets.
- + Two split system Air conditioning + ceiling fans.
- + Double carport with large driveway and room for extra parking
- + Rear patio & under house storage / workshop

Type : House

View : <https://www.rangeagents.com/8507353>

[For full version visit the website](https://www.rangeagents.com)

38 South Pacific Avenue, Mount Pritchard

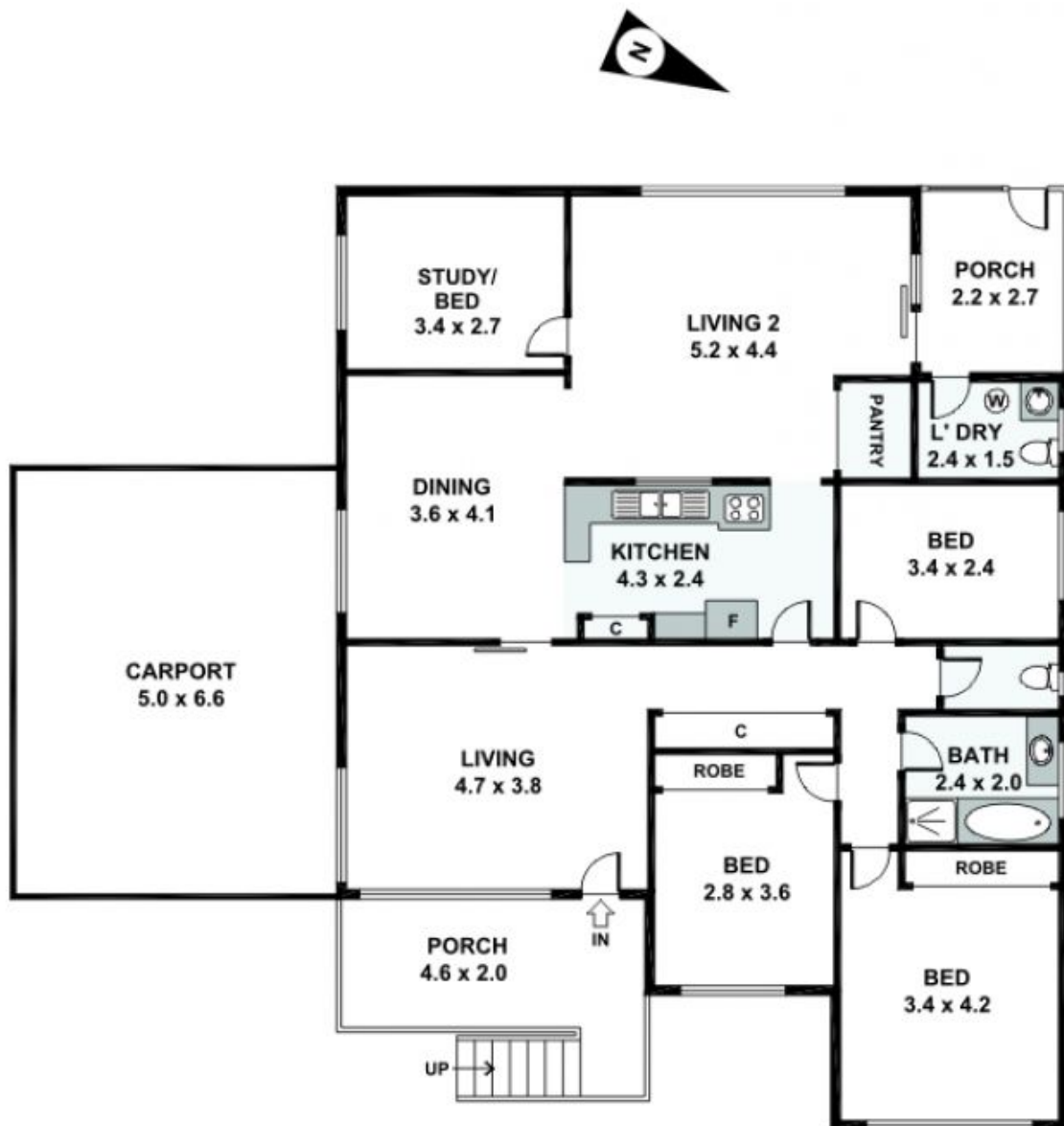

Please note: All stated dimensions are approximate only. Particulars given are for general information only and do not constitute any representation on the part of the vendor or agent.